

Grade 8 Science

Unit 1: Introduction and Safety

Science Lab Safety

Last year we discussed a variety of safety aspects in regards to the science lab. This year we will review those concepts, as they will apply again this year (and beyond).

Please take a copy of "Science Lab Safety." On this sheet you will find three safety based activities. These are fairly basic activities that are meant to stimulate conversation.

Please begin the first activity, "Safe Practises", as soon as you get your sheet.

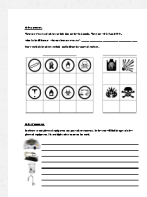

Now that you have had time to look over the image and write down some of your thoughts, we are going to have a competition. In your table group, using a laptop, record as many unsafe activities as you can find in the image. You have until the timer sounds to make your list.

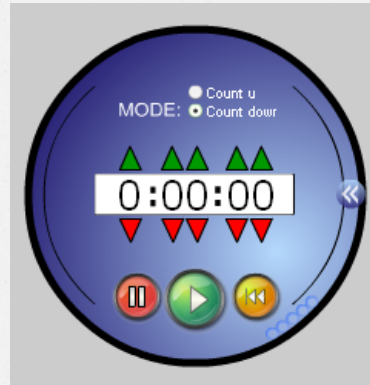
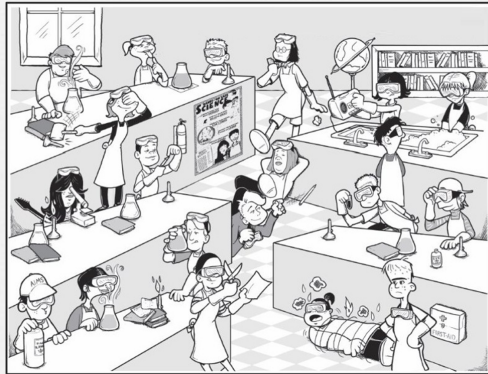

Let the competition begin...

Round 2: Who has the most diverse list?

We will circle around the room, each group coming up and circling one thing from their list. When you can not circle something new, your team is eliminated.

Please begin working on the second activity, on the back of the page.
We will take this up when the timer sounds.

The first person to get all 14 perfectly will get a bonus on their safety quiz.

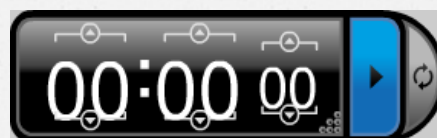

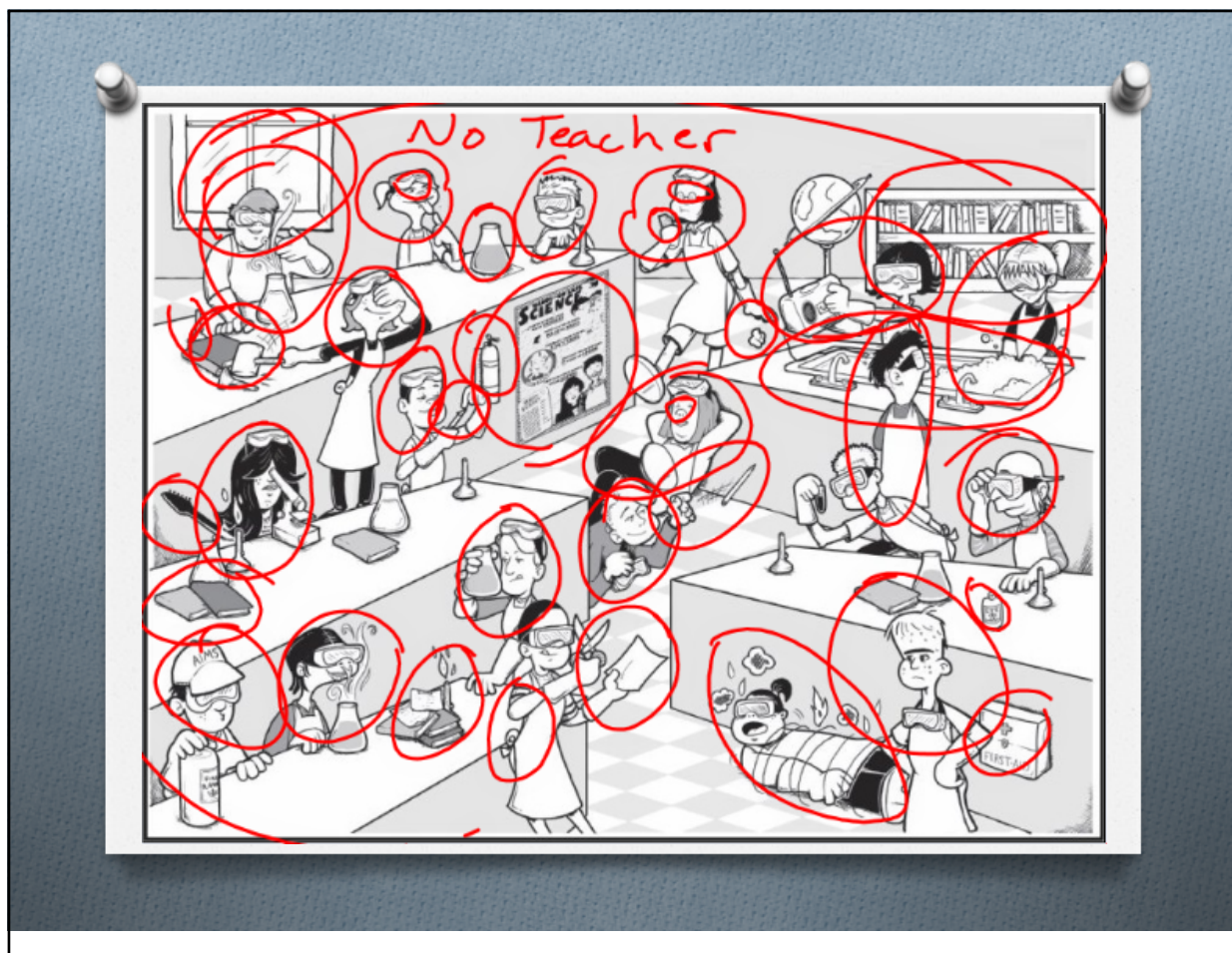

Science Lab Safety

WHMIS

Gas Under Pressure	Flammable	Oxidizing	Corrosive	Environmental Hazard
Harmful or Fatal (in small amounts)	Harmful - Skin, Eyes, Respiratory	Health Hazard	Explosive	Biohazard

HAPS

Corrosive	Explosive
Flammable	Poisonous

Science Lab Safety

I would now like you to complete the last activity on your worksheet. On the paper there are images of four pieces of equipment found in this science lab. Please list safety concerns for all of them.



Fumes
Burn
Fire
Sharp
Electrical



chemicals
Sharp
Hot

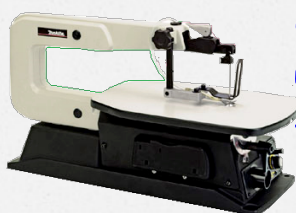

Cuts
Wood chips
Saw dust - slip
Electrical



Electrical
Slips
Hot

YOU HAVE A TEST IN TWO PERIODS:

Your test will cover the following concepts:

- You will need to be familiar with the parts of the scientific method (lesson 2)
- You will need to recognize WHMIS and HHPS symbols
- You will need to be mindful of unsafe actions in the science lab as well as safety concerns with lab equipment.

If you are able, please bring your phone/tablet to your next class.

Being that there are only 3 things that are required for your binder this unit, I will be checking it at the end of your next unit. Please be sure not to lose your work.

Attachments

1-6 Safety Search.jpg

1-6 Science Lab Safety.pdf